

MODEL - SP-IDP-DHP07/24  
SP-IDP-DHP27/54

Applied Unit:  
Multi-Split Ceiling Ducted Type

### Drain Pump

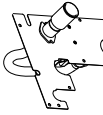

**IMPORTANT**  
READ AND UNDERSTAND THIS MANUAL  
BEFORE USING THIS DRAIN PUMP. KEEP  
THIS MANUAL FOR FUTURE REFERENCE.

### IMPORTANT NOTICE

- Read and understand this manual before using this drain pump. If the instructions are not followed, it may result in a serious water leakage, a drain pump where there is a high level of oil mist, dust, flammable gases, salty air or harmful gases.
- Our company's liability shall not cover defects arising from the alteration performed by a customer without Cooper & Hunter's written form.
- This manual is reserved to vary specifications without notice.
- No part of this manual may be reproduced without written permission.
- Signal words (DANGER, NOTE) are used to identify levels of hazard seriousness.
- Definitions for identifying hazard levels are provided below with their respective signal words.

**DANGER**: Immediate hazards which WILL result in severe personal injury or death.

**NOTE**: Useful information for operation and/or maintenance.  
**CHECKING PRODUCT RECEIVED**

- Upon receiving this product, inspect it for any shipping damage. Claims for damage, either apparent or concealed, should be made immediately.
- Check the model and quantity to determine if they are correct.

### 1. Before Installation

**NOTE**  
Please check the number of drain pump components and accessories according to the table.

No.	Accessory	Qty	Purpose
1	Drain Pump	1	Collect the water from the indoor unit and discharge it to the drain pipe.
2	Drain Pipe	1	Connect the drain pipe to the drain pipe.
3	Drain Pipe Clamp	1	Secure the drain pipe to the drain pipe.
4	Drain Pipe Insulation	1	Prevent the drain pipe from freezing.
5	Drain Pipe Sealant	1	Prevent the drain pipe from leaking.
6	Drain Pipe Connector	1	Connect the drain pipe to the drain pipe.
7	Drain Pipe Adapter	1	Connect the drain pipe to the drain pipe.
8	Drain Pipe Elbow	1	Connect the drain pipe to the drain pipe.
9	Drain Pipe Tee	1	Connect the drain pipe to the drain pipe.
10	Drain Pipe Coupling	1	Connect the drain pipe to the drain pipe.
11	Drain Pipe Cap	1	Close the end of the drain pipe.
12	Drain Pipe Plug	1	Close the end of the drain pipe.
13	Drain Pipe Seal	1	Prevent the drain pipe from leaking.
14	Drain Pipe Gasket	1	Prevent the drain pipe from leaking.
15	Drain Pipe O-ring	1	Prevent the drain pipe from leaking.
16	Drain Pipe Washer	1	Prevent the drain pipe from leaking.
17	Drain Pipe Nut	1	Secure the drain pipe to the drain pipe.
18	Drain Pipe Bolt	1	Secure the drain pipe to the drain pipe.
19	Drain Pipe Screw	1	Secure the drain pipe to the drain pipe.
20	Drain Pipe Nail	1	Secure the drain pipe to the drain pipe.
21	Drain Pipe Staple	1	Secure the drain pipe to the drain pipe.
22	Drain Pipe Glue	1	Secure the drain pipe to the drain pipe.
23	Drain Pipe Sealant	1	Prevent the drain pipe from leaking.
24	Drain Pipe Gasket	1	Prevent the drain pipe from leaking.
25	Drain Pipe O-ring	1	Prevent the drain pipe from leaking.
26	Drain Pipe Washer	1	Prevent the drain pipe from leaking.
27	Drain Pipe Nut	1	Secure the drain pipe to the drain pipe.
28	Drain Pipe Bolt	1	Secure the drain pipe to the drain pipe.
29	Drain Pipe Screw	1	Secure the drain pipe to the drain pipe.
30	Drain Pipe Nail	1	Secure the drain pipe to the drain pipe.
31	Drain Pipe Staple	1	Secure the drain pipe to the drain pipe.
32	Drain Pipe Glue	1	Secure the drain pipe to the drain pipe.

- If any of these accessories are not packed, please contact your contractor.
- The indoor unit installation should meet the relative instructions.

### 2. Installation

#### 2.1 Drain Pump Installation

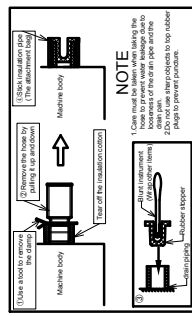

3. The drain pump assembly is close to the air conditioner body, the hose and the power cable terminal is inserted into the substrate PCNB. The specific steps are as follows.

- Confirm the connection of the drain pump assembly. Insert the hose to prevent water leakage into the drain pipe.
- Tread through the crossing hole of the cover plate assembly (Fig. 4).

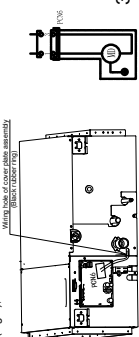

- Remove the blue terminal protection cover of the base PCNB, insert the power terminal of the pump into the hole, and secure it with the insulation seal ring.
- Note: Do not leave the blue terminal cover PCB inside the machine.



- Check that the earth wire is securely connected if the drain pump is not correctly grounded. It will lead electric shock.
- 4. Use screws to assemble the pump assembly with the electrical cover. As shown below.

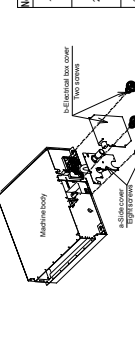

- Pay attention to the gap between the piping and the damping block when installing the drain pump to avoid collision.
- 5. The position of the drain piping connection is shown in Fig. 6.

Use a rubber stopper to seal the drain of the original drain pipe connected to the drain port of the water receiving plate. Move the drain pipe directly to the drain port of the pump for connection.

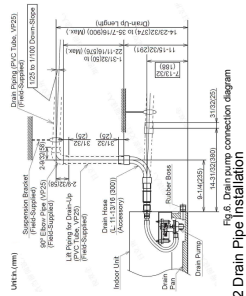

- The drain pipe must be connected with a down slope which is 1/50-1/100. Upper slope or rising part will lead to water flowing back and drainage leakage.
- Fasten the tube to the drain hose with the adhesive agent.
- Insulate the drain pipe using the polyvinyl chloride packing (thickness 8mm above) to avoid water condensing and drip.

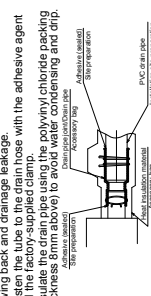

3. After Installation

- Check for Float Switch Action: After the drain pump is installed, inject water into the water tray. Switch ON the power supply of the drain pump. Check that the water flows smoothly or whether no water leakage. If the water pipe does not flow out of water, then inject 680z (liters) of water into the drain pump for abnormal noise.
- Actual wiring operation, check if there is any abnormal sound of the drain pump.
- Drainage inspection: After the drain pump is installed, check for leaks at the drain pipe.

- 4. Fault/problem troubleshooting: If there is any problem after installation, please refer to the following table for maintenance.

No.	Fault point	Maintenance measures
1	Alarm code 01	1. Check the drain pump wiring (Reference 2.1.3). 2. Check if there is any water or drainage failure in the drain pipe. 3. Check whether the original water pan drain is tightly connected. 4. Check that the rubber plug is installed and damaged. 5. Check that the slope of the drain pipe is appropriate. 6. Check that the drain pipe is not blocked with debris. 7. Check that the drain pipe is not blocked with debris.
2	Water tray leaking	1. Check that the water tray is not blocked with debris. 2. Check that the drain pipe is not blocked with debris. 3. Check that the drain pipe is not blocked with debris.
3	Drainage pipe leaking	1. Check if the installation of the clamp and drain is in place. 2. Check if the drain pipe is not blocked with debris. 3. Check if the drain pipe is not blocked with debris.
4	Leakage in cover parts	1. Check if the drain pump assembly is correctly installed. 2. Check if the drain pump assembly is correctly installed. 3. Check if the drain pump assembly is correctly installed.
5	Running noise	1. Check if the drain pump is in contact with other parts. 2. Check if the drain pump assembly is correctly installed. 3. Check if the drain pump assembly is correctly installed.